

M2.06.01 (rev.0 - 1st September 2021).

Table of ingots dimensions and weights.

All weights and dimensions must be considered indicative.

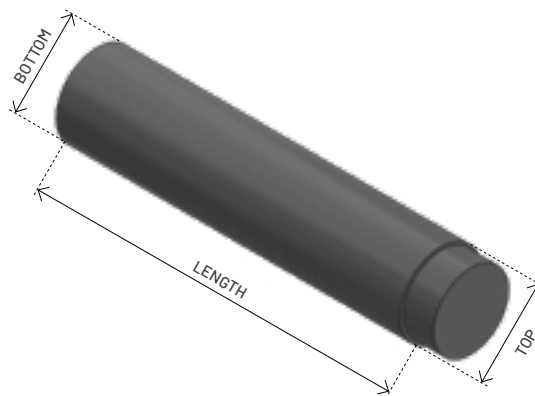

Round Ingots

INGOT	SIDES n°	INGOTS PER HEAT		DIMENSIONS				TOTAL WEIGHT [kg]		WEIGHT WITHOUT TOP [kg]		BOTTOM WEIGHT [kg]
				TOP Ø [mm]	BOTTOM Ø [mm]	LENGTH [mm]						
						min	max	min	max	min	max	
310	-	11	12	300	310	4.130		2.550		2.400	N	
380	-	7	8	370	380	4.350		3.900		3.780	N	
420	-	6	8	420	420	4.310		4.770		4.600	N	
480	-	5	6	480	480	4.280		6.250		5.970	N	
540	-	4	5	540	540	4.320		7.900		7.600	N	
600	-	3	4	610	620	3.910	4.330	9.330	10.300	8.960	9.930	N
680	-	3	4	670	670	3.890	4.300	11.150	12.250	10.600	11.700	N
800	-	2	4	800	810	2.960	4.410	12.800	18.550	11.720	17.470	N
900	-	2	3	890	890	2.580	3.970	13.870	20.600	12.510	19.240	N
1000	-	1	2	990	990	4.000	5.130	26.000	32.850	24.190	31.040	160
1000B	-	2		990	990	2.400		16.250		14.430		160
1200	-	1	2	1.200	1.200	2.640	4.640	27.240	44.700	24.040	41.500	1.000
1300	24	1		1.280	1.280	2.840		31.450		28.250		1.000
1450	-	1		1.450	1.450	2.020	3.880	32.600	56.300	26.650	50.350	1.000

The number of ingots is related to the total weight of the cast:

- Minimum melt weight = 26.600 kg
- Maximum AOD capacity = 40.000 kg

Different combinations of ingots or special requests of weight may be discussed with the Commercial Department.